

# Sustainable University Day | 12 November 2024 | Zurich

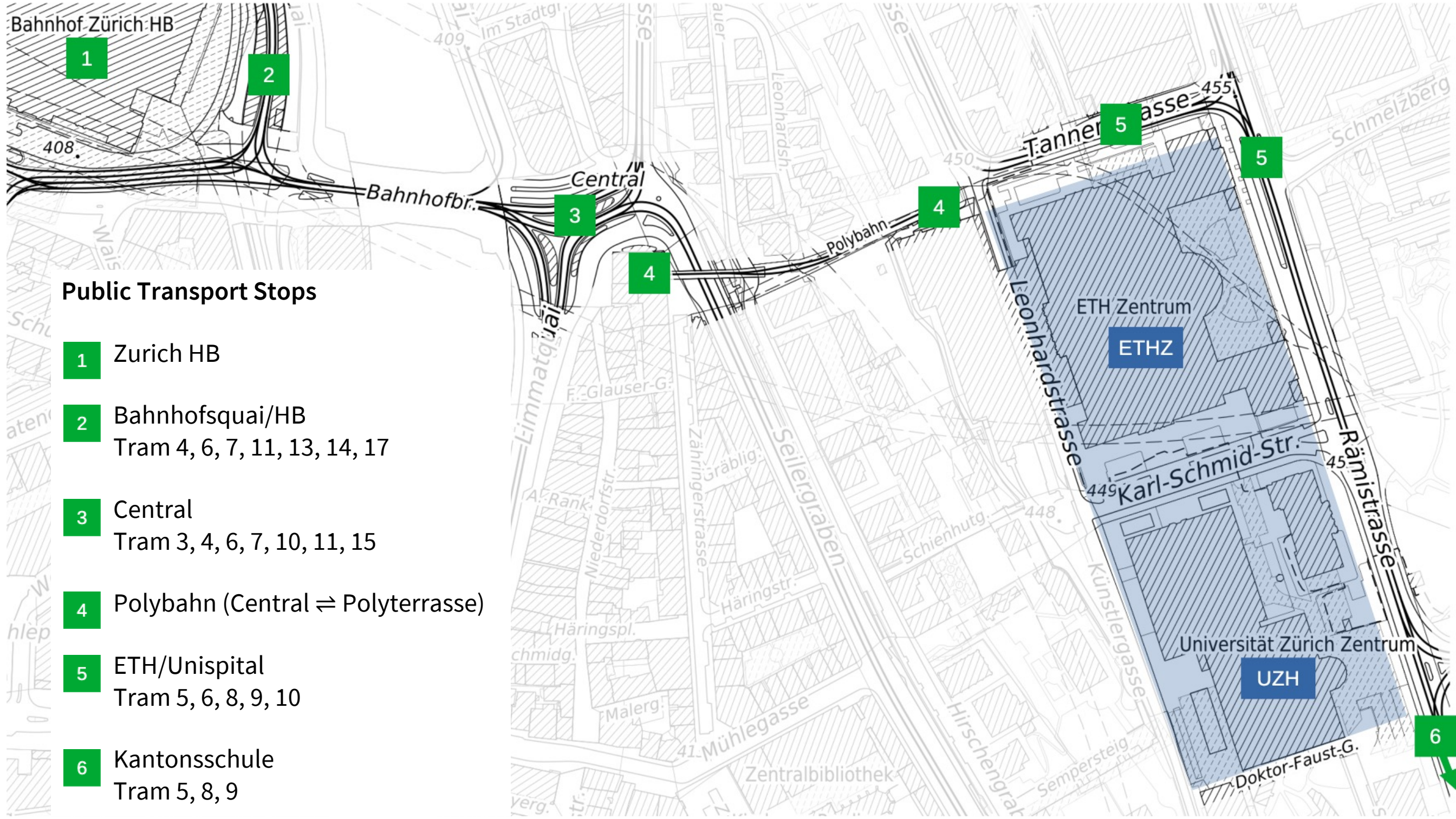

## Public Transport Stops

- 1** Zurich HB
- 2** Bahnhofsquai/HB  
Tram 4, 6, 7, 11, 13, 14, 17
- 3** Central  
Tram 3, 4, 6, 7, 10, 11, 15
- 4** Polybahn (Central ⇌ Polyterrasse)
- 5** ETH/Unispital  
Tram 5, 6, 8, 9, 10
- 6** Kantonsschule  
Tram 5, 8, 9

Quelle Karte: [opendata.swiss maps.zh.ch/](https://opendata.swiss/maps.zh.ch/)

# Sustainable University Day | 12 November 2024 | Zurich

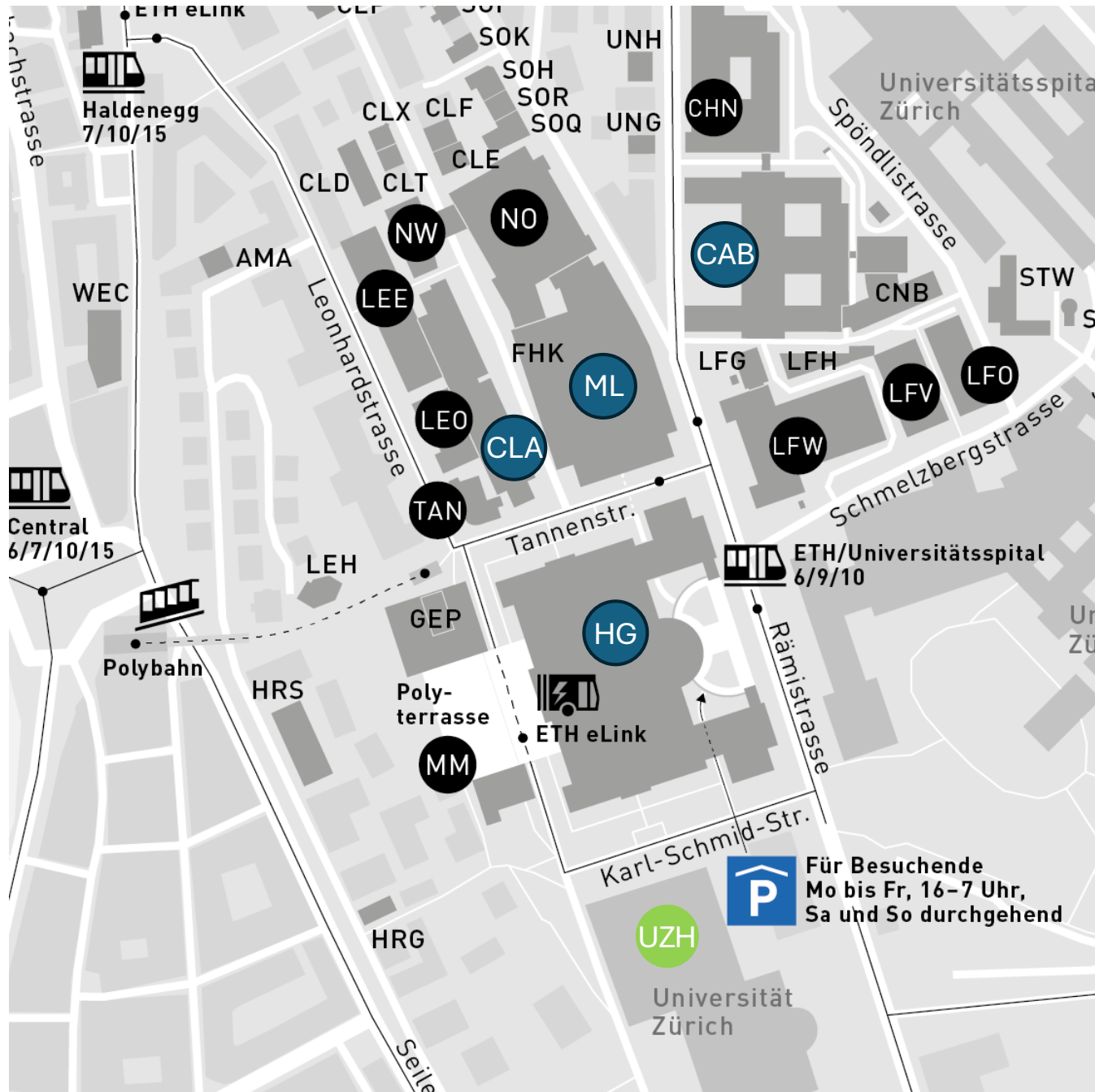

- HG** **ETH main building (Rämistrasse 101)**  
*Plenary sessions – HG F 30 (Audimax)*  
*Inputs, workshops*
- UZH** **UZH main building (Rämistrasse 71)**  
*Inputs, lunch and idea forum – Lichthof*
- CAB** **ETH CAB (Universitätstrasse 6)**  
*Workshop, apéro*
- CLA** **ETH CLA (Tannenstrasse 3)**  
*Workshops*
- ML** **ETH ML (Tannenstrasse 3)**  
*Workshops*

# Sustainable University Day | 12 November 2024 | Zurich

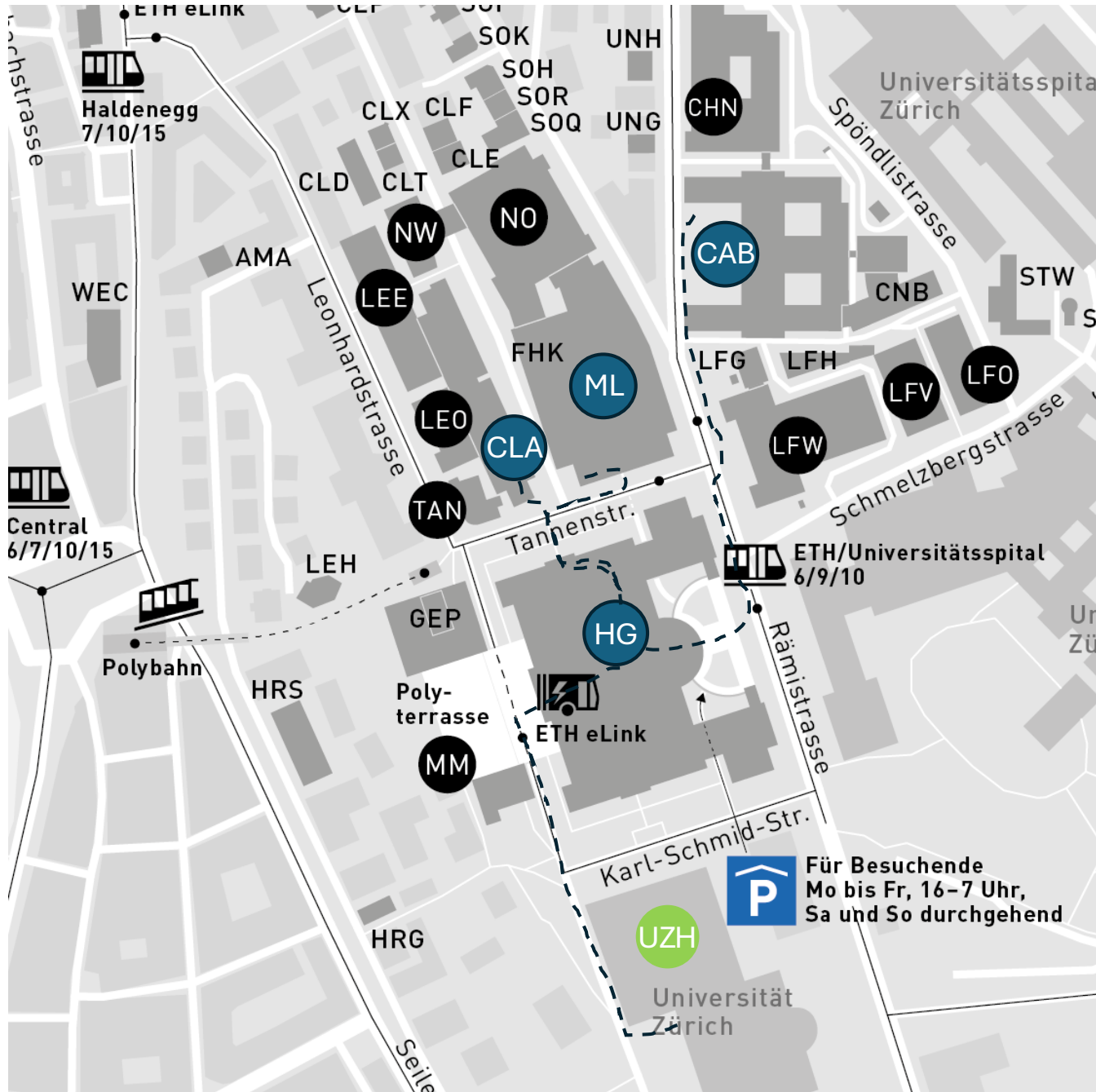

- HG** **ETH main building (Rämistrasse 101)**  
*Plenary sessions – HG F 30 (Audimax)*  
*Inputs, Workshops*
- UZH** **UZH main building (Rämistrasse 71)**  
*Inputs, lunch and idea forum – Lichthof*
- ML** **ETH ML (Tannenstrasse 3)**  
Workshops
- CLA** **ETH CLA (Tannenstrasse 3)**  
Workshops
- CAB** **ETH CAB (Universitätstrasse 6)**  
Workshops, apéro

# Sustainable University Day | 12 November 2024 | Zurich

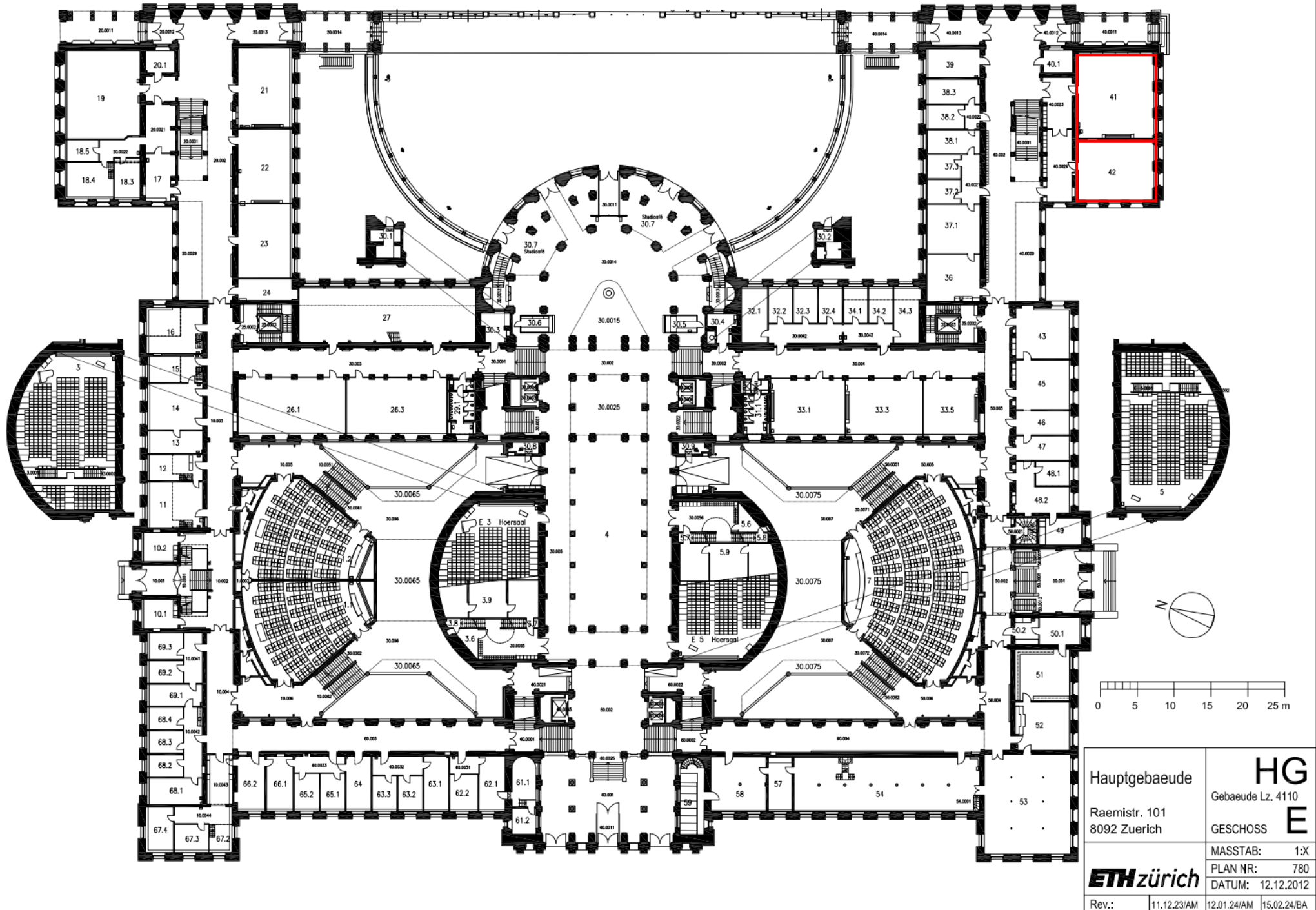

# Sustainable University Day | 12 November 2024 | Zurich

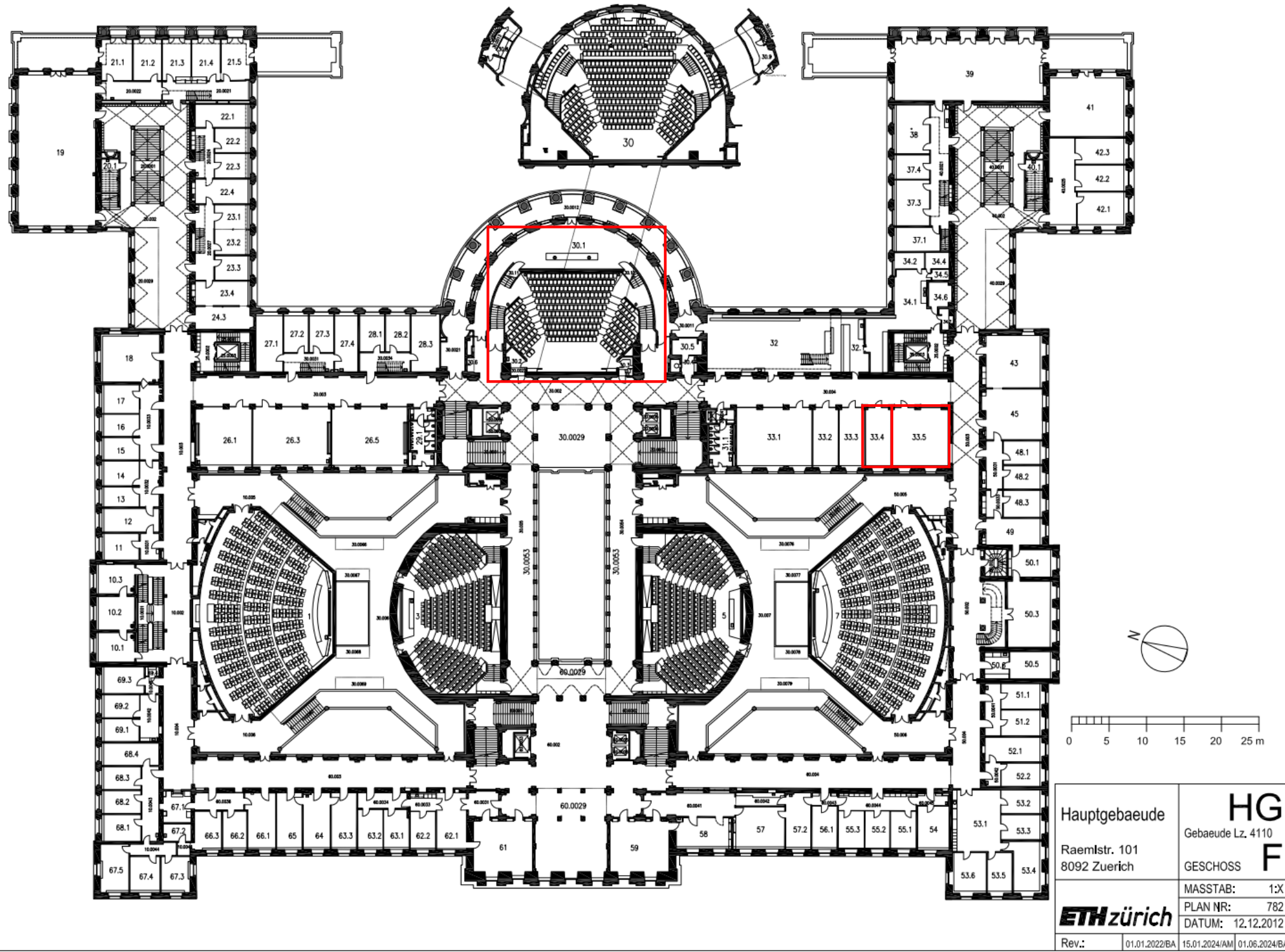

# Sustainable University Day | 12 November 2024 | Zurich

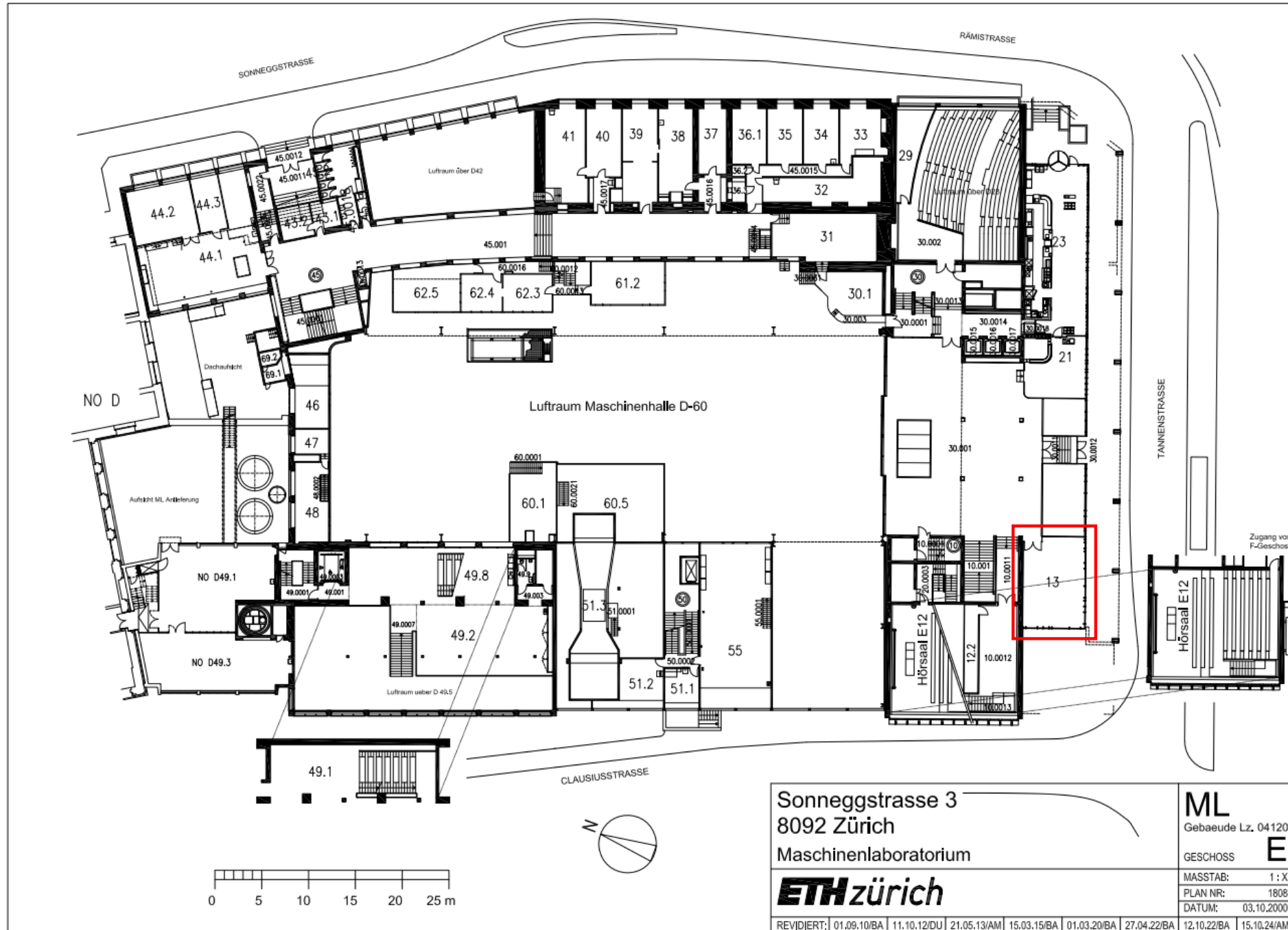

# Sustainable University Day | 12 November 2024 | Zurich

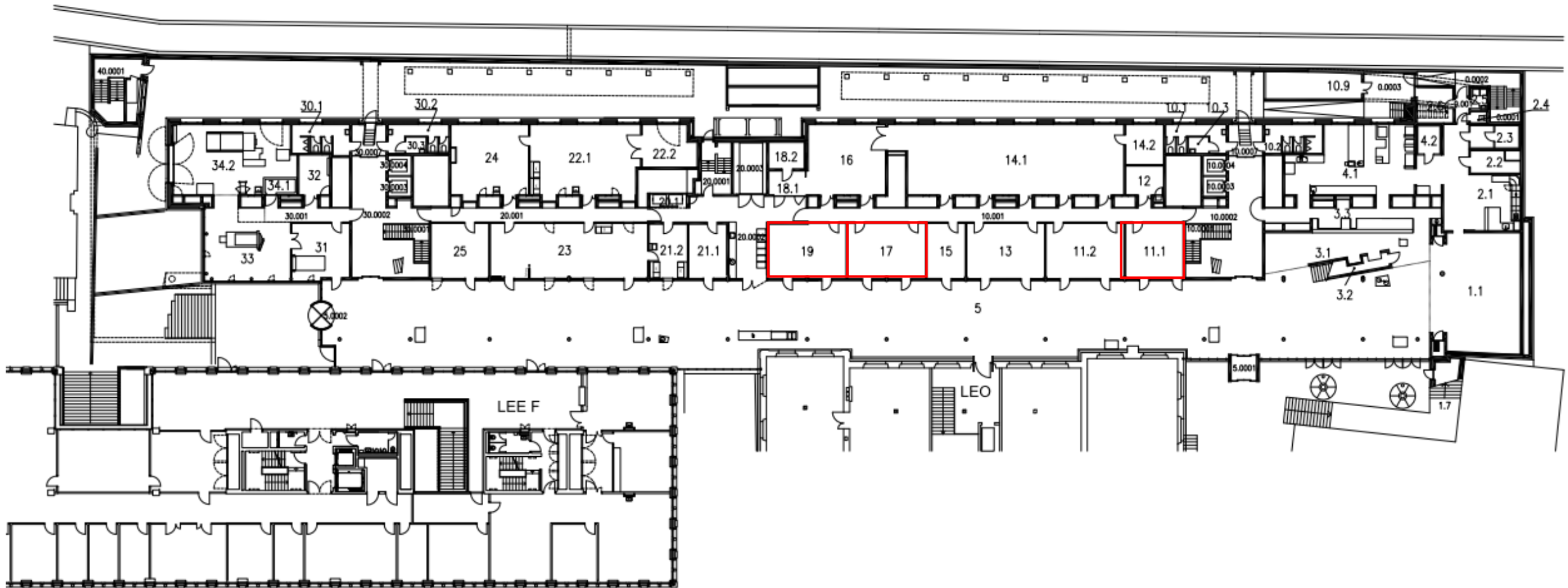

0 5 10 15 20 METER







Tannenstrasse 3 8092 Zürich		CLA Gebäude Lz. 4129
<b>ETH zürich</b>		GESCHOSS <b>D</b>
REVIDIERT:		MASSTAB: 1 : X
19.01.11/DU   25.06.14/BA   07.11.16/BA   01.11.17/BA   25.08.22/BA   21.11.23/AM   18.12.23/AM		PLAN NR: 1397
		DATUM: 31.07.1999





## Legend

-  Mensa/Café
-  Stairs
-  Lift
-  Toilets
-  Lichthof  
Ideas Forum

← ETHZ

## UZH Floor D

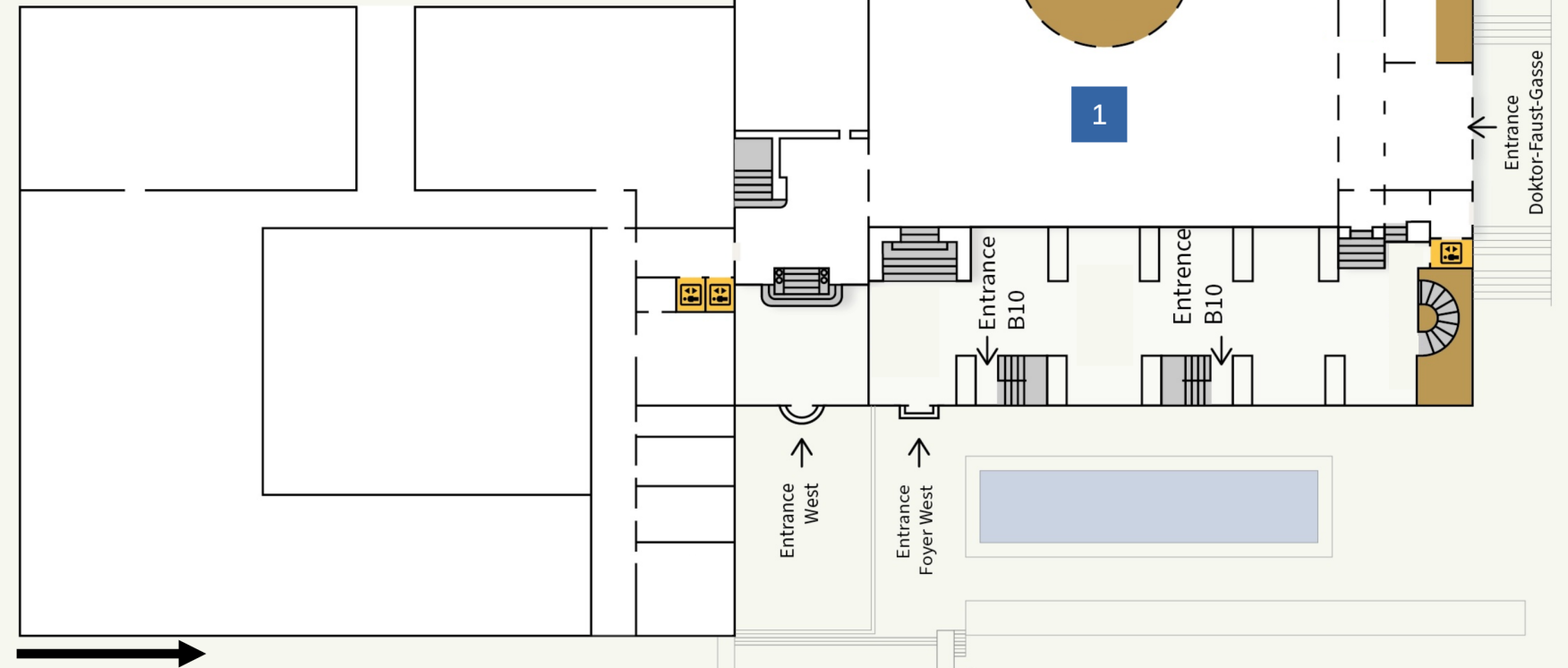

Access from ETHZ via Polyterrasse

## UZH Floor E



Access from ETHZ via  
Rämistrasse

Main Entrance

### Legend



 Mensa/Café

 Stairs

 Lift

 Toilets

 Information Desk



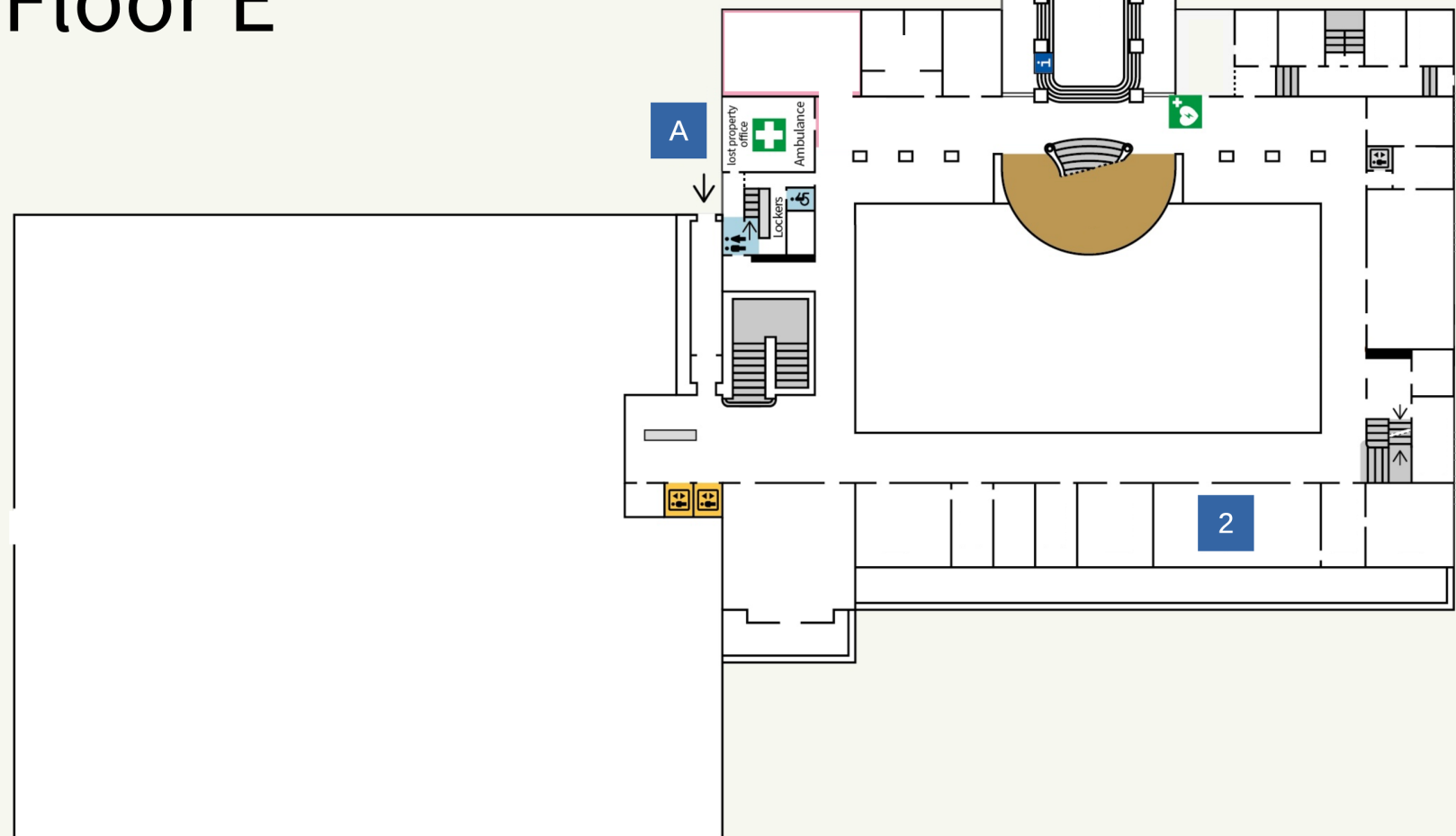

 UZH KOL-E-13 EV  
 Input Transform. Science

 Accessible Entrance from Rämistrasse

←  
ETHZ



## Legend

-  Mensa/Café
-  Stairs
-  Lift
-  Toilets
-  UZH KO2-F-152 EV  
📍 Input Inner Development



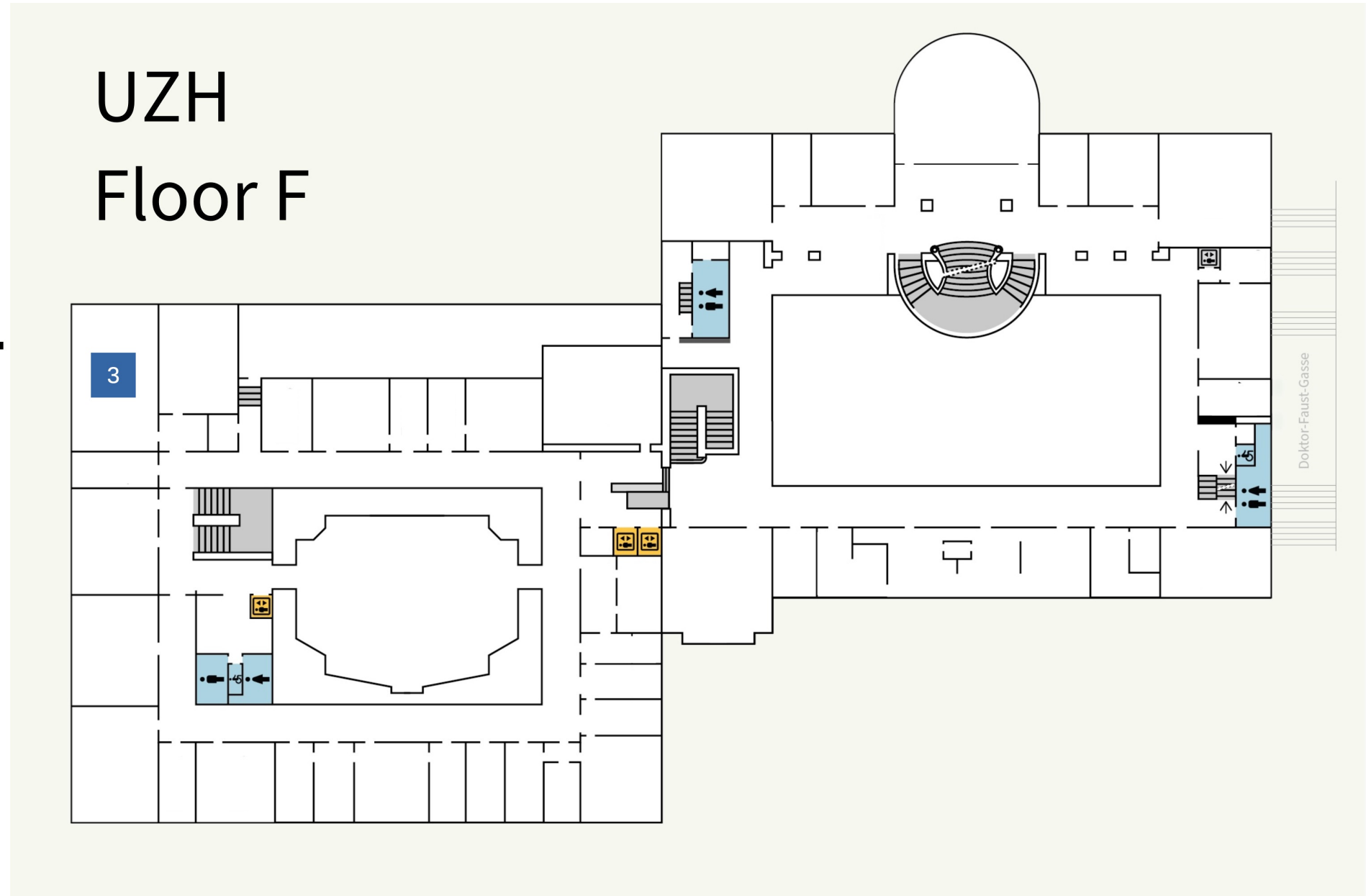

← ETHZ



## UZH Floor H



### Legend

-  Mensa/Café
-  Stairs
-  Lift
-  Toilets
-  UZH KOL-H-309 EV  
Input Zukunftsbilder

